

Optional Patio
extended 2m

Optional Kitchen Shown

Living Area : 101 m²
Patio 12 m

Jasper

Unit Size 15m x 7.2m



HOEK MODULAR HOMES

PO BOX 70 PETRIE QLD 4502 Phone: 3889 7385 Fax: 3889 7386

BSA LICENCE NO : 1169 135 Email: sales@hoekmodularhomes.com



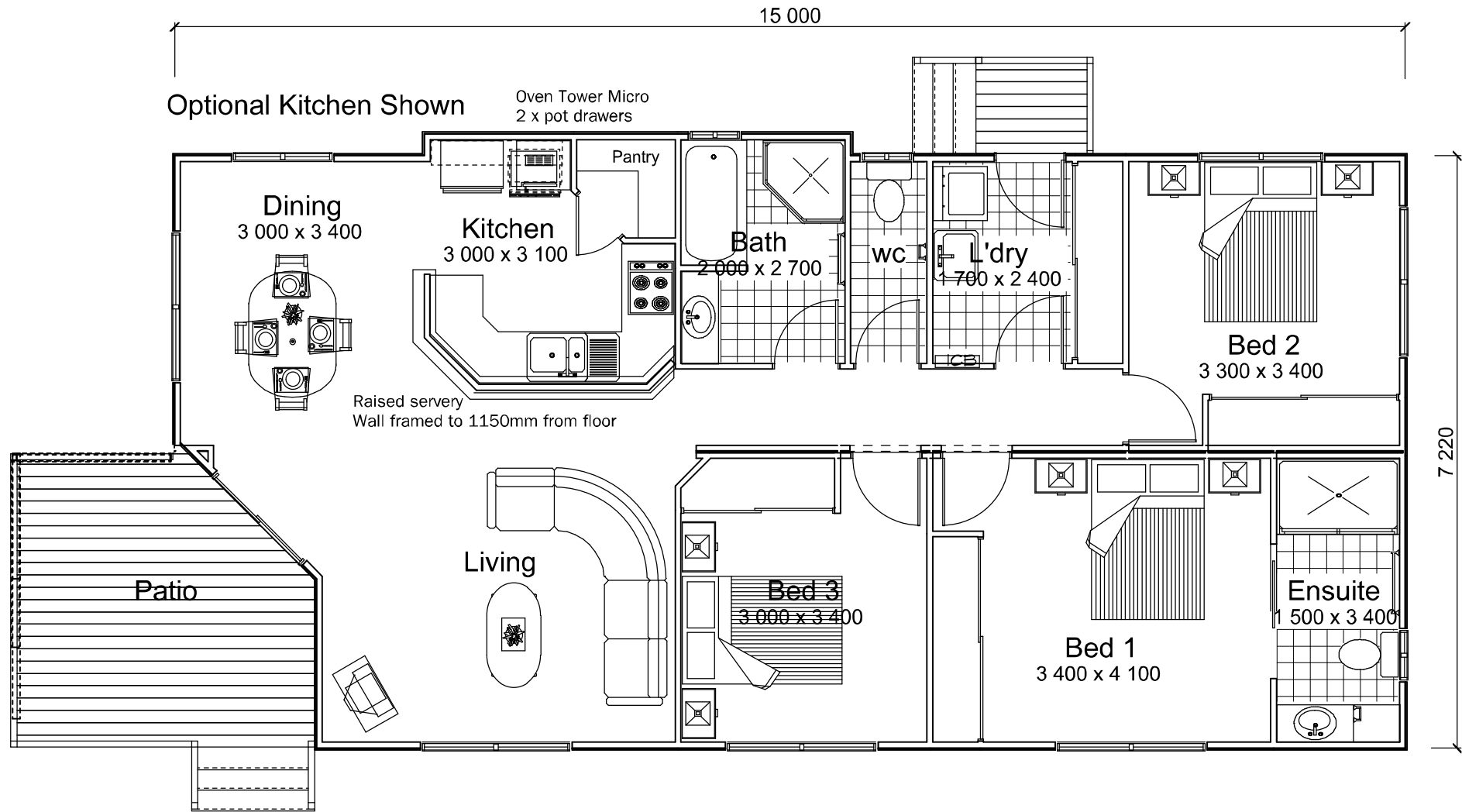

Optional Kitchen Shown

Oven Tower Micro
2 x pot drawers

Dining
3 000 x 3 400

Kitchen
3 000 x 3 100

Bath
2 000 x 2 700

wc
L'dry
1 700 x 2 400

Bed 2
3 300 x 3 400

Raised servery
Wall framed to 1150mm from floor

Patio

Living

Bed 3
3 000 x 3 400

Bed 1
3 400 x 4 100

Ensuite
1 500 x 3 400

Optional Patio
extended 2m

Jasper V2

Unit size 15m x 7.2m

Living Area : 105.7 m²
Deck 12 m

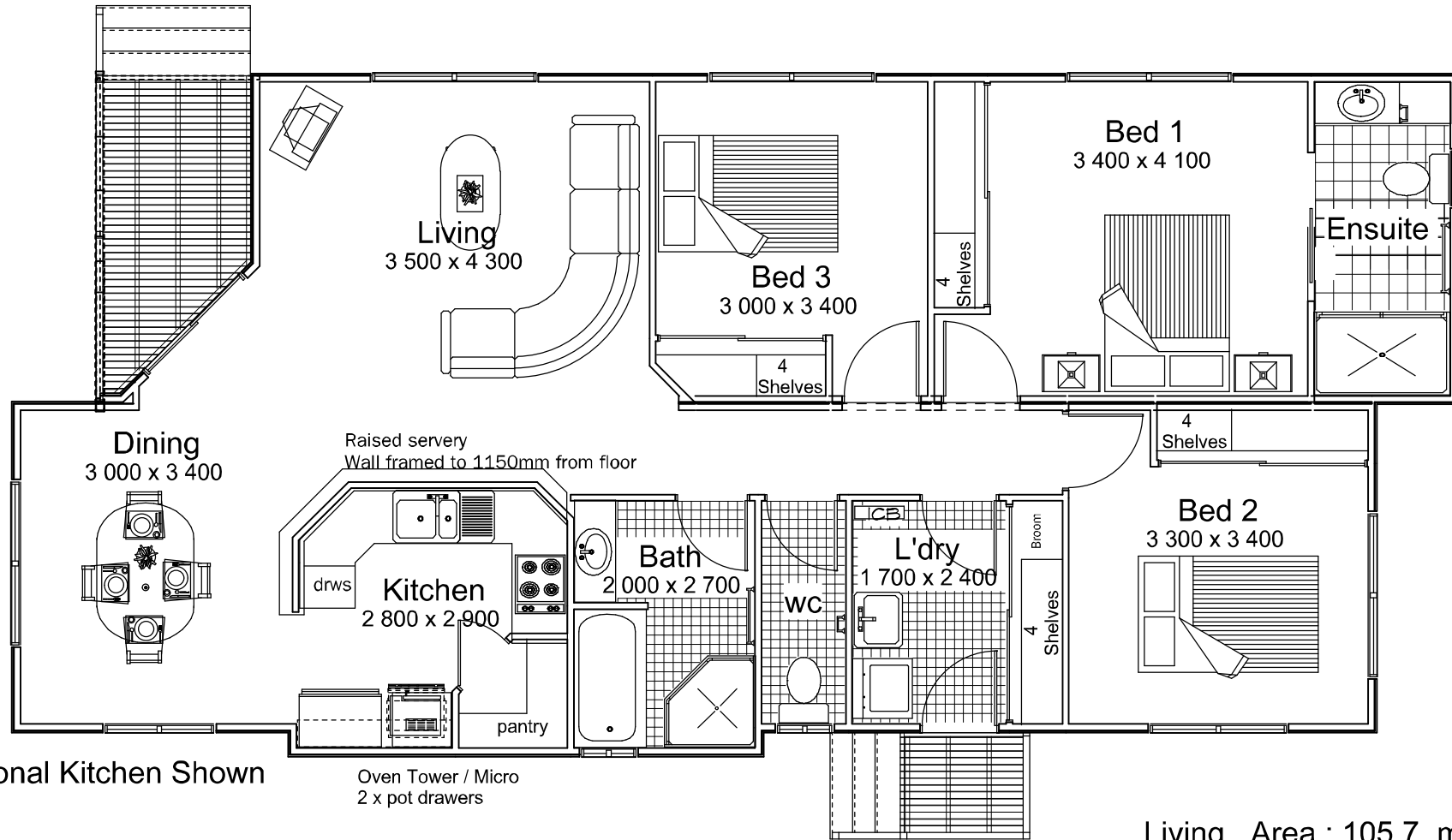

Optional Kitchen Shown

Oven Tower / Micro
2 x pot drawers

Living Area : 105.7 m²
Deck 5.3 m

Jasper V3

Unit size 15m x 7.2m



HOEK MODULAR HOMES

PO BOX 70 PETRIE QLD 4502 Phone: 3889 7385 Fax: 3889 7386

BSA LICENCE NO : 1169 135 Email: sales@hoekmodularhomes.com

